

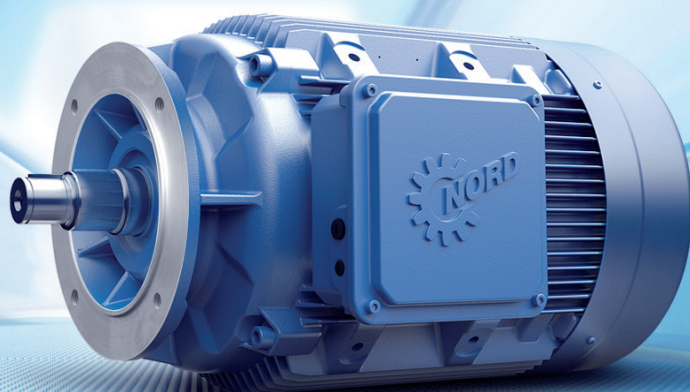

Intelligent Drivesystems, Worldwide Services

ELEKTROMOTOREN 30 – 55 kW



DE

PRODUKTKATALOG
M7002

DRIVESYSTEMS

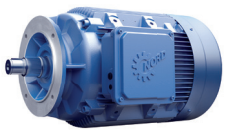

OPTIONEN

MOTOREN 30 – 55 kW

Kurzzeichen	Bedeutung
BRE +	Bremse / Bremsmoment + Suboption
DBR +	Doppelbremse + Suboption
RG*	rostgeschützte Ausführung
SR*	staub- und rostgeschützte Ausführung
HL	Handlüftung
MIK	Mikroschalter
* nicht bei DBR	
BSH	Stillstandsheizung / Bremse
NRB1/2	Geräuschreduzierte Bremse
ERD	äußere Erdungsklemme
TF	Temperaturfühler, Kaltleiter
TW	Temperaturwächter, Bimetall
SH	Stillstandsheizung
WE	2. Wellenende
RD	Schutzdach
RDD	doppelte Lüfterhaube
KB	verschl. Kondenswasserbohrung
KKV	Klemmenkasten vergossen
FEU	Feuchtschutzisolation
TRO	Tropenschutzisolation
VIK	Vorschrift - Vereinigung Industrieller Kraftwirtschaft
F	Fremdlüfter
RLS	Rücklaufsperr
IG1 (IG11, 12)	Drehgeber 1024 Impulse, Inkremental
IG2 (IG21, 22)	Drehgeber 2048 Impulse, Inkremental
IG4 (IG41, 42)	Drehgeber 4096 Impulse, Inkremental
IG.K	Drehgeber mit Klemmenkasten
AG	Absolutwertgeber

Informationen zu Optionen, welche nicht in den Massbildern abgebildet sind, erhalten Sie auf Anfrage!

Bremsen Standardzuordnung

Type			BRE 250	BRE 400	BRE 800
	IE2	IE3	MB [Nm]		
225		RP	250	400	
	SH	SP	250	400	
	MH	MP		400	800
250	WH	WP		400	800
Mehrgewicht [kg]			32	50	53
J [10 ⁻³ kgm ²]			6,65	19,5	39

Bitte kontaktieren Sie Ihren NORD Ansprechpartner für weitere Informationen zu den technischen Daten der Optionen und Bremsen.

TECHNISCHE DATEN

MOTOREN 30 – 55 kW

IE2 50 Hz

Type	P _N	n _N	M _N	I _N		cos φ	η			η ¹⁾	M _A /M _N	M _K /M _N	I _A /I _N	J	Gew.
				230V	400V		1/2xPN	3/4xPN	4/4xPN						
	[kW]	[1/min]	[Nm]	[A]	[A]		[%]	[%]	[%]	[%]				[kgm ²]	[kg]
225 SH/4	37	1480	239	120	69,5	0,85	94,4	94,2	93,7	93,3	2,6	3,0	6,9	0,49	315
225 MH/4	45	1480	290	141	81,4	0,84	94,4	94,5	94	94	2,6	2,7	6,9	0,60	340
250 WH/4	55	1480	355	172	99,3	0,84	94,2	94,4	94	94	2,7	3,0	7,4	0,74	380

IE2 60 Hz

Type	P _N	n _N	M _N	I _N		cos φ	η			η ¹⁾	M _A /M _N	M _K /M _N	I _A /I _N	J	Gew.
				265V	460V		1/2xPN	3/4xPN	4/4xPN						
	[kW]	[1/min]	[Nm]	[A]	[A]		[%]	[%]	[%]	[%]				[kgm ²]	[kg]
225 SH/4	37	1785	198	102	58,9	0,84	93,7	94,5	94,5	94	2,9	3,3	8,2	0,49	315
225 MH/4	45	1785	241	123	71,2	0,83	94,2	94,8	94,6	94,5	3,1	3,2	8,2	0,60	340
250 WH/4	55	1785	294	151	87,2	0,84	94,2	94,8	94,7	94,3	3,0	3,3	8,5	0,74	380

* Bauform B5, ohne Optionen / η¹⁾ Schlechtester Wert in der Weitbereichsgrenze

IE3 50 Hz

Type	P _N	n _N	M _N	I _N		cos φ	η			M _A /M _N	M _K /M _N	I _A /I _N	J	Gew.	
				230V	400V		1/2xPN	3/4xPN	4/4xPN						
	[kW]	[1/min]	[Nm]	[A]	[A]		[%]	[%]	[%]					[kgm ²]	[kg]
225 RP/4	30	1485	193	97,3	56,2	0,82	93,6	94,3	94,1	3,0	3,4	7,8	0,49	315	
225 SP/4	37	1485	238	118	68,2	0,83	93,6	94,4	94,1	2,9	3,2	7,7	0,54	330	
225 MP/4	45	1485	289	142	81,7	0,83	94,6	94,9	94,6	3,0	3,4	8,0	0,67	365	
250 WP/4	55	1480	355	166	96,1	0,87	95,2	95	94,6	2,6	2,8	7,0	0,82	400	

IE3 60 Hz

Type	P _N	n _N	M _N	I _N		cos φ	η			M _A /M _N	M _K /M _N	I _A /I _N	J	Gew.	
				265V	460V		1/2xPN	3/4xPN	4/4xPN						
	[kW]	[1/min]	[Nm]	[A]	[A]		[%]	[%]	[%]					[kgm ²]	[kg]
225 RP/4	30	1785	160	85,7	49,5	0,81	93,4	94,4	94,5	3,4	3,8	8,9	0,49	315	
225 SP/4	37	1785	198	103	59,7	0,82	93,6	94,5	94,6	3,0	3,7	8,8	0,54	330	
225 MP/4	45	1785	241	125	72,0	0,83	94,6	95,2	95,2	3,3	3,6	9,1	0,67	365	
250 WP/4	55	1785	294	146	84,4	0,86	95,2	94,5	95,4	2,9	3,2	8,2	0,82	400	

* Bauform B5, ohne Optionen



BAUREIHE NORD B3 IEC

Motordaten

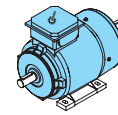
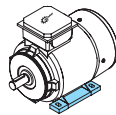
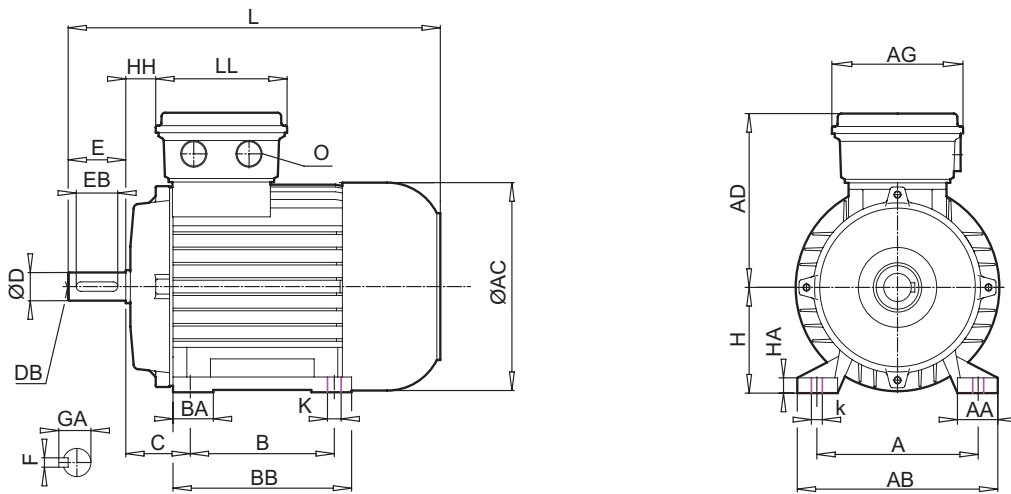

Type	IE2	IE3	[mm]															
			A	AA	AB	B	BA	BB	HA	k	K	AC	AD	AG	C	H	HH	L
225	SH	SP	356	79	443	286	66	359	20	25	20	443	347	245	149	225	94	882
225	MH	MP	356	79	443	311	66	359	20	25	20	443	347	245	149	225	94	882
225		RP	356	79	443	286	66	359	20	25	20	443	347	245	149	225	94	882

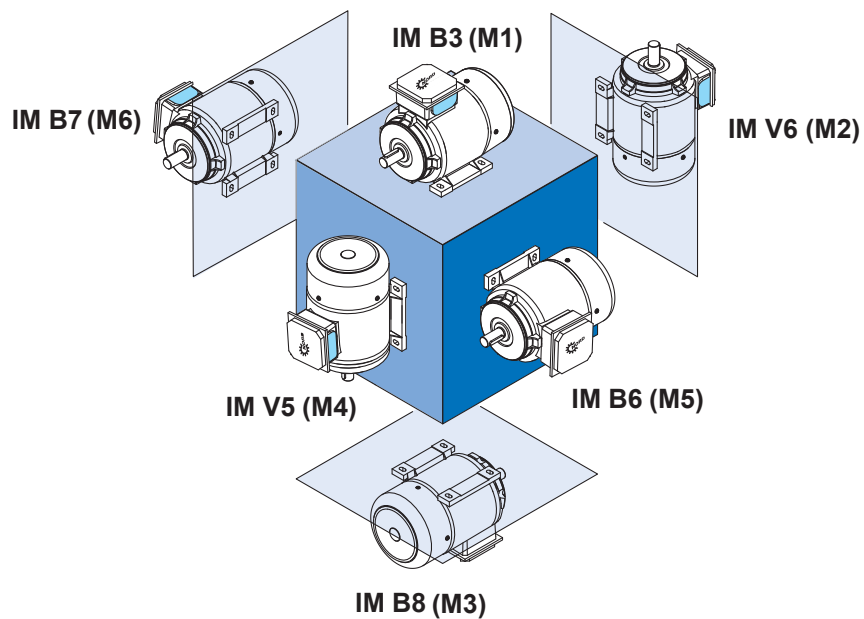

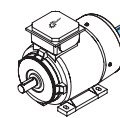
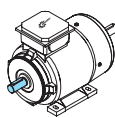
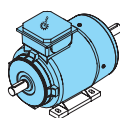
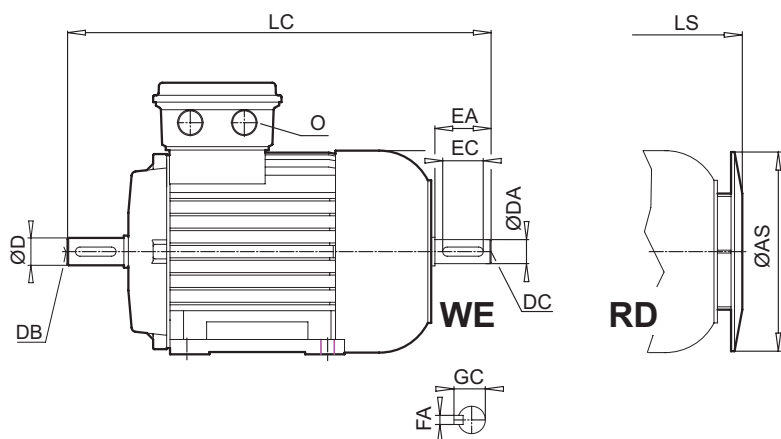

[mm]

LC	LL	AS	LS	O	D	DB	E	EB	F	GA	DA	DC	EA	EC	FA	GC
1002	245	348	968,5	M50 x 1,5	60	M20	140	125	18	64	55	M20	110	100	16	59
1002	245	348	968,5	M50 x 1,5	60	M20	140	125	18	64	55	M20	110	100	16	59
1002	245	348	968,5	M50 x 1,5	60	M20	140	125	18	64	55	M20	110	100	16	59

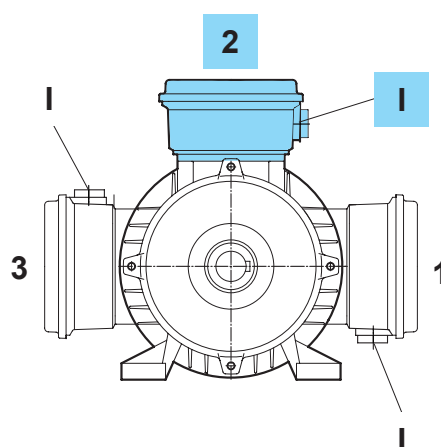
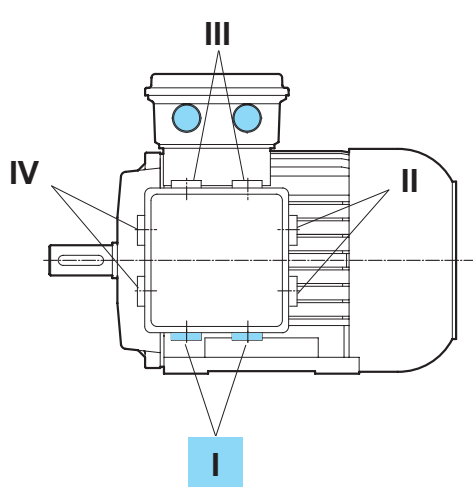



BAUREIHE NORD B5 IEC

Motordaten

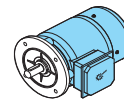
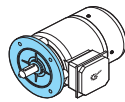
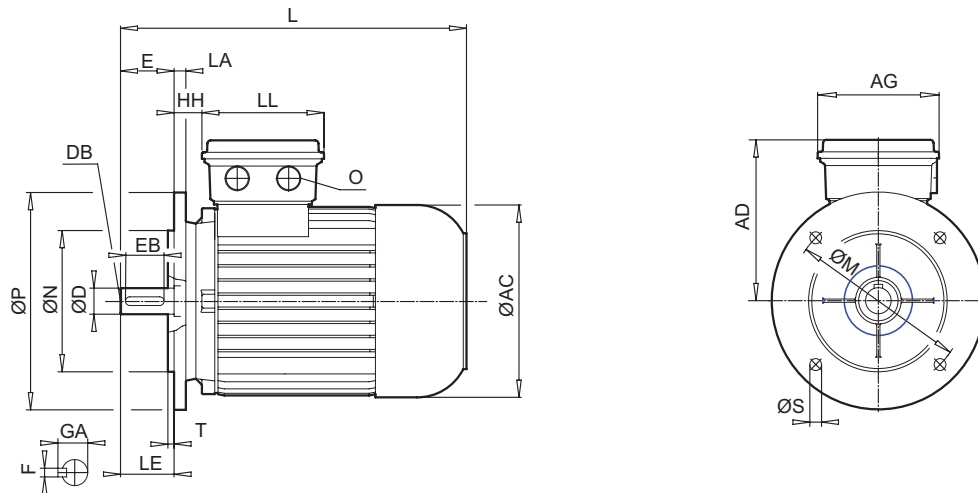

Type	IE2	IE3	[mm]													
			LA	M	N	P	S	T	AC	AD	AG	HH	L	LC	LE	LL
225	SH	SP	20	400	350	450	17,5	5	443	347	245	94	882	1002	140	245
225	MH	MP	20	400	350	450	17,5	5	443	347	245	94	882	1002	140	245
225		RP	20	400	350	450	17,5	5	443	347	245	94	882	1002	140	245

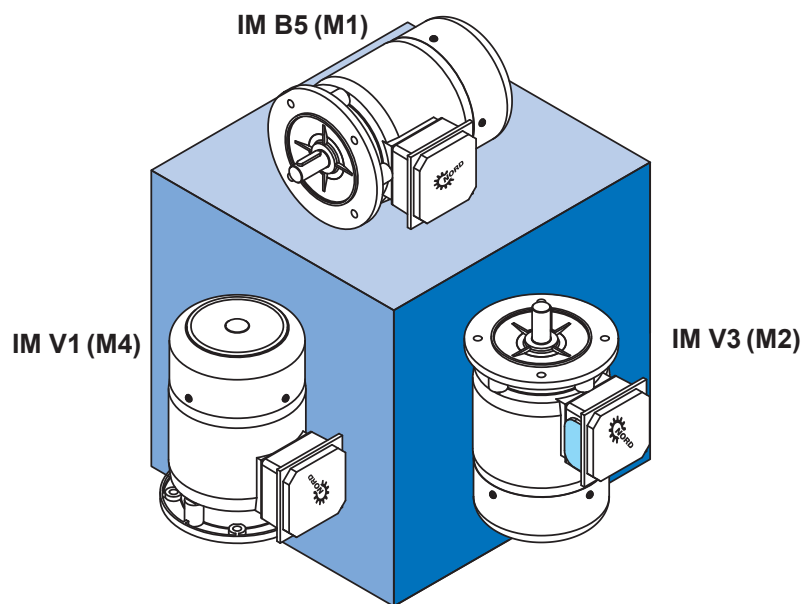

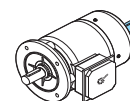
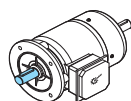
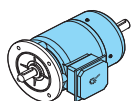
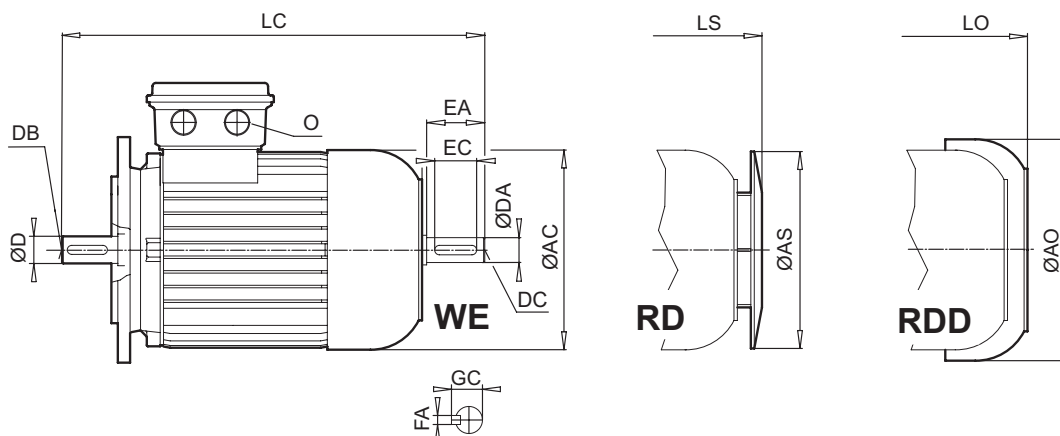

[mm]

AS	LS	O	D	DB	E	EB	F	GA	DA	DC	EA	EC	FA	GC
348	968,5	M50 x 1,5	60	M20	140	125	18	64	55	M20	110	100	16	59
348	968,5	M50 x 1,5	60	M20	140	125	18	64	55	M20	110	100	16	59
348	968,5	M50 x 1,5	60	M20	140	125	18	64	55	M20	110	100	16	59

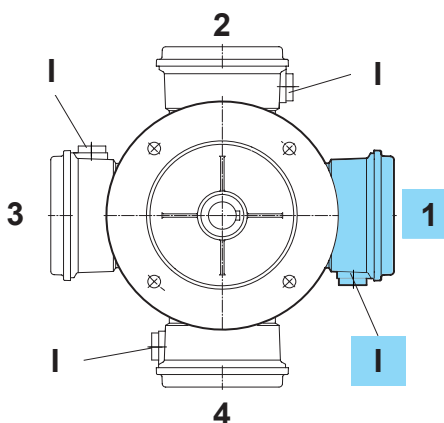
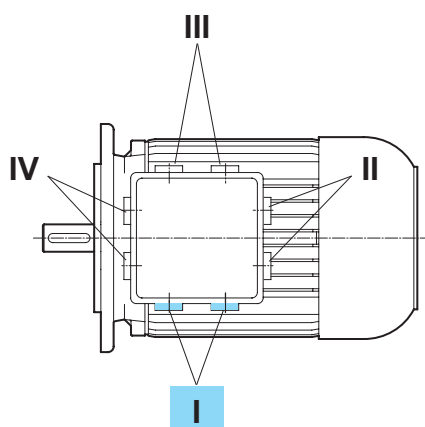

Motordaten



BAUREIHE NORD IEC B3 BRE

Motordaten

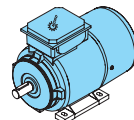
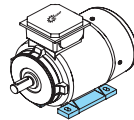
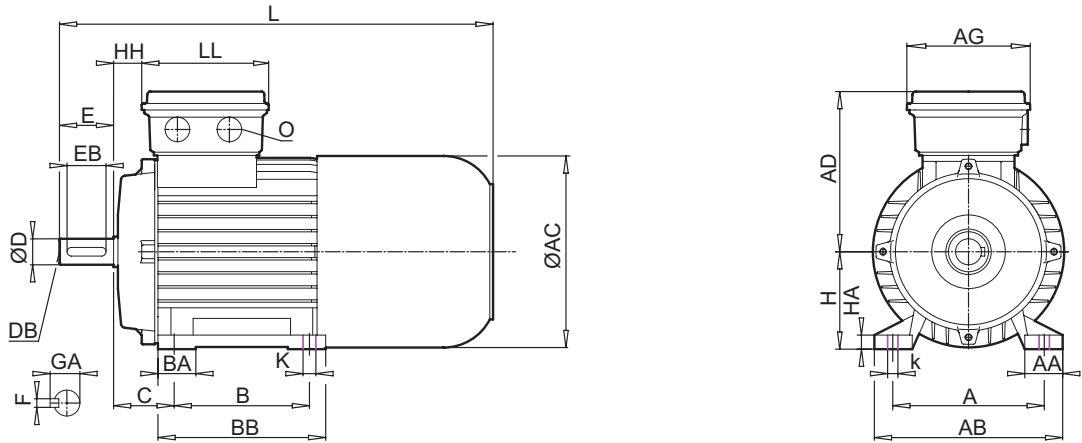

Type	IE2	IE3	[mm]																
			A	AA	AB	B	BA	BB	HA	k	K	AC	AD	AG	C	H	HH	L	
225	SH	SP	356	79	443	286	66	359	20	25	20	443	347	245	149	225	94	1062	
225	MH	MP	356	79	443	311	66	359	20	25	20	443	347	245	149	225	94	1062	
225		RP	356	79	443	286	66	359	20	25	20	443	347	245	149	225	94	1062	

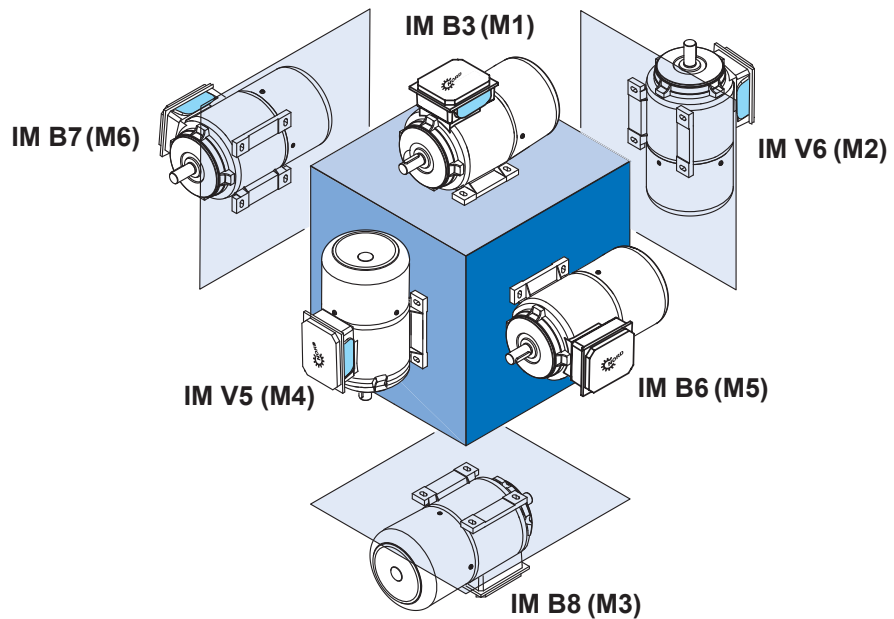

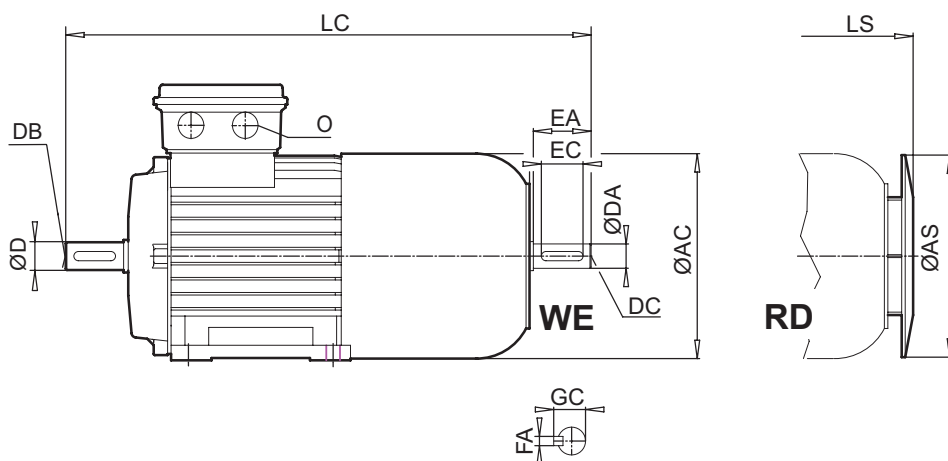

Motordaten

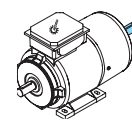
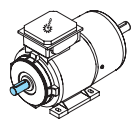
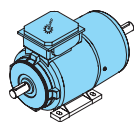

[mm]

LC	LL	AS	LS	O	D	DB	E	EB	F	GA	DA	DC	EA	EC	FA	GC
1182	245	348	1148,5	M50 x 1,5	60	M20	140	125	18	64	55	M20	110	100	16	59
1182	245	348	1148,5	M50 x 1,5	60	M20	140	125	18	64	55	M20	110	100	16	59
1182	245	348	1148,5	M50 x 1,5	60	M20	140	125	18	64	55	M20	110	100	16	59

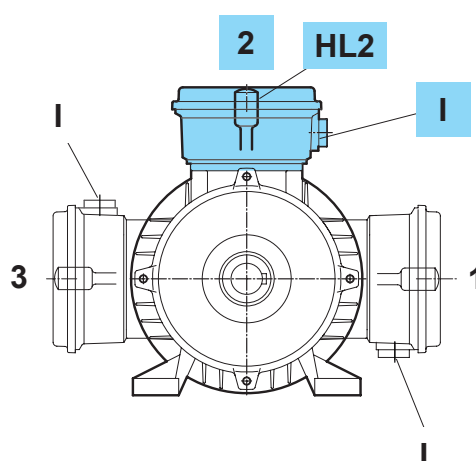
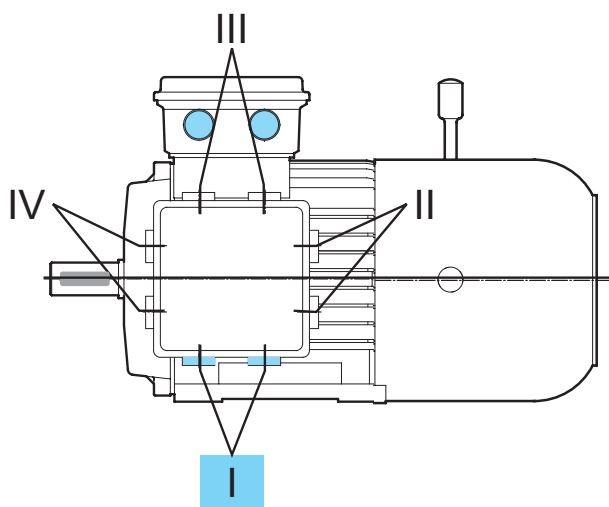



BAUREIHE NORD IEC B5 BRE

Motordaten

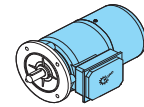
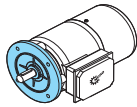
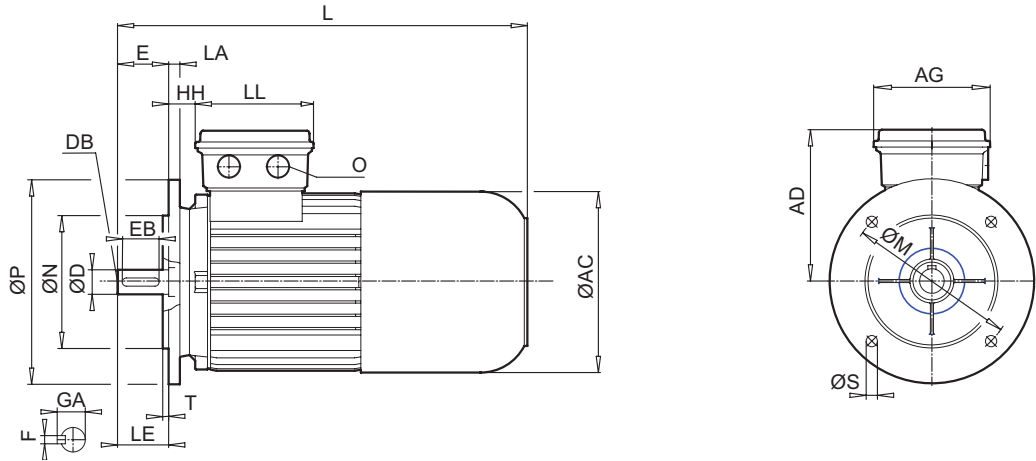

Type	IE2	IE3	[mm]												
			LA	M	N	P	S	T	AC	AD	AG	HH	L	LC	LL
225	SH	SP	20	400	350	450	17,5	5	443	347	245	94	1062	1182	245
225	MH	MP	20	400	350	450	17,5	5	443	347	245	94	1062	1182	245
225		RP	20	400	350	450	17,5	5	443	347	245	94	1062	1182	245

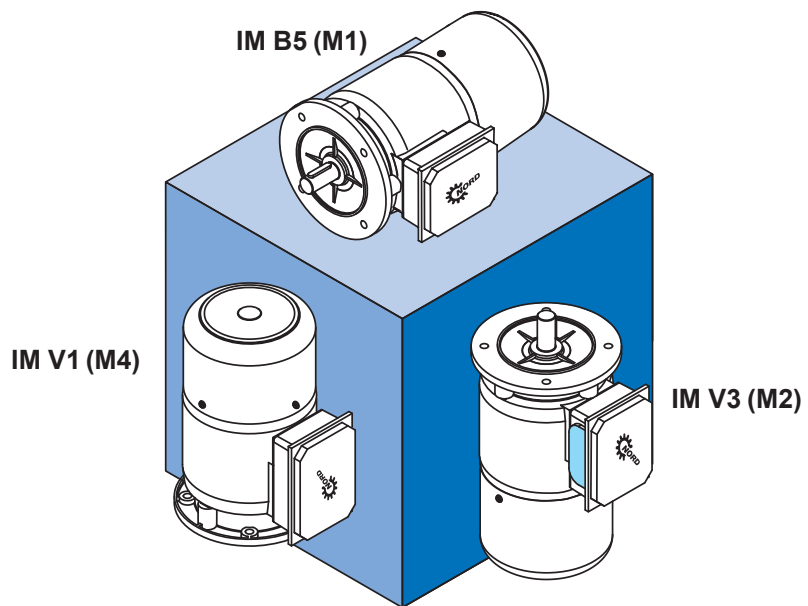

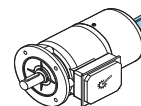
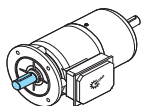
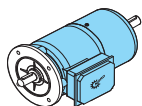
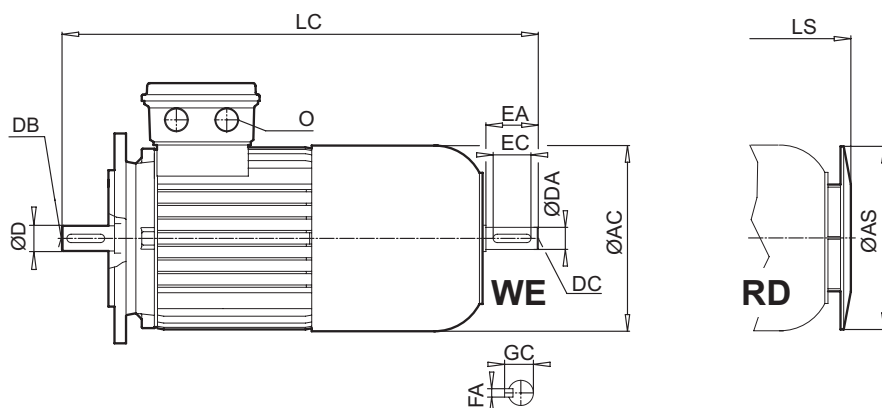

[mm]

AS	LS	O	D	DB	E	EB	F	GA	DA	DC	EA	EC	FA	GC
348	1148,5	M50 x 1,5	60	M20	140	125	18	64	55	M20	110	100	16	59
348	1148,5	M50 x 1,5	60	M20	140	125	18	64	55	M20	110	100	16	59
348	1148,5	M50 x 1,5	60	M20	140	125	18	64	55	M20	110	100	16	59

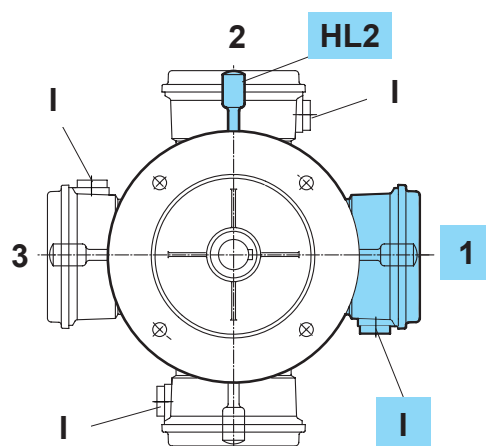
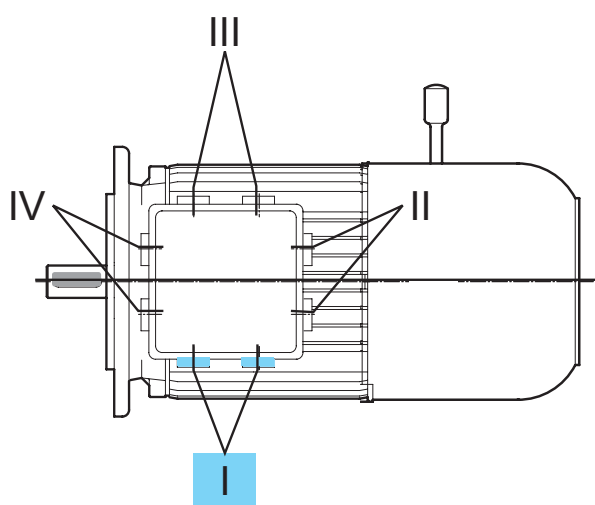



BAUREIHE NORD B5 WERKNORM

Motordaten

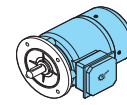
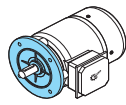
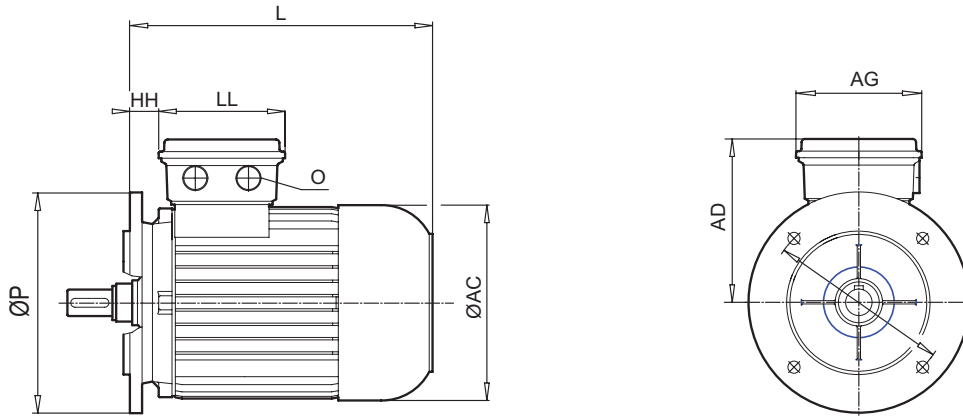

Type	IE2	IE3	WN-Pos.	P	AC	AD	AG	HH	L	LC	LL
225	SH		28	350	433	347	245	94	742	862	245
225	SH		78	350	443	347	245	94	742	862	245
225	SH		69	300	443	347	245	94	742	862	245
225	MH		30	350	443	347	245	94	742	862	245
225	MH		80	350	443	347	245	94	742	862	245
250	WH		32	450	443	347	245	94	742	892	245
250	WH		82	450	443	347	245	94	742	892	245
225		RP	26	350	443	347	245	94	742	862	245
225		RP	76	350	443	347	245	94	742	862	245
225		RP	68	300	443	347	245	94	742	862	245
225		SP	28	350	443	347	245	94	742	862	245
225		SP	78	350	443	347	245	94	742	862	245
225		SP	69	350	443	347	245	94	742	862	245
225		MP	30	350	443	347	245	94	742	862	245
225		MP	80	350	443	347	245	94	742	862	245
250		WP	32	450	443	347	245	94	742	892	245
250		WP	82	450	443	347	245	94	742	892	245

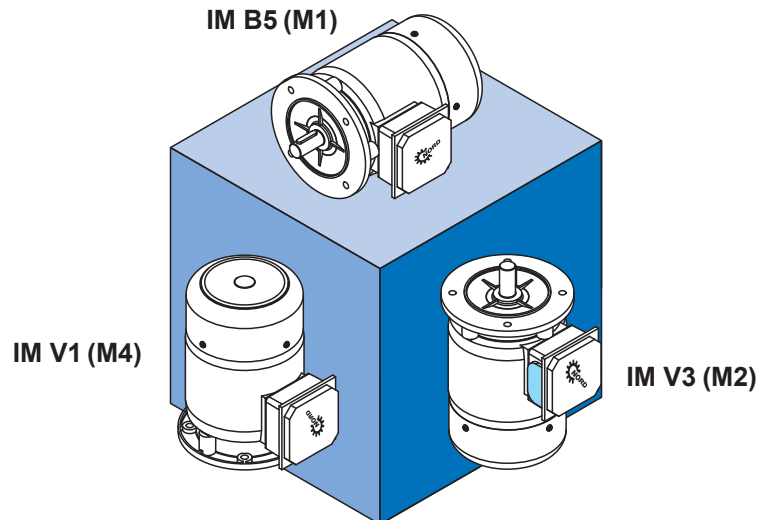

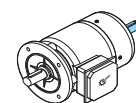
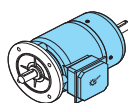
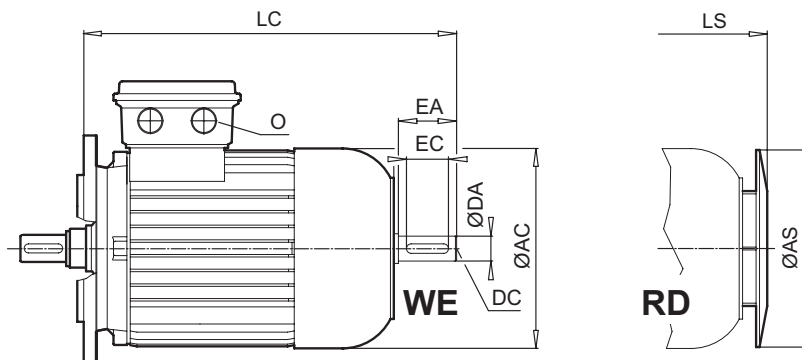

[mm]	AS	LS	O	DA	DC	EA	EC	FA	GC
	348	828,5	M50 x 1,5	55	M20	110	100	16	59
	348	828,5	M50 x 1,5	55	M20	110	100	16	59
	348	828,5	M50 x 1,5	55	M20	110	100	16	59
	348	828,5	M50 x 1,5	55	M20	110	100	16	59
	348	828,5	M50 x 1,5	55	M20	110	100	16	59
	348	828,5	M63 X 1,5	60	M20	140	125	18	64
	348	828,5	M63 X 1,5	60	M20	140	125	18	64
	348	828,5	M50 X 1,5	55	M20	110	100	16	59
	348	828,5	M50 X 1,5	55	M20	110	100	16	59
	348	828,5	M50 X 1,5	55	M20	110	100	16	59
	348	828,5	M50 X 1,5	55	M20	110	100	16	59
	348	828,5	M50 X 1,5	55	M20	110	100	16	59
	348	828,5	M50 X 1,5	55	M20	110	100	16	59
	348	828,5	M50 X 1,5	55	M20	110	100	16	59
	348	828,5	M50 X 1,5	55	M20	110	100	16	59
	348	828,5	M63 X 1,5	60	M20	140	125	18	64
	348	828,5	M63 X 1,5	60	M20	140	125	18	64

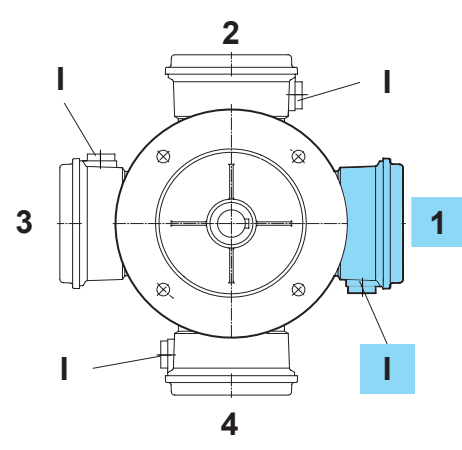
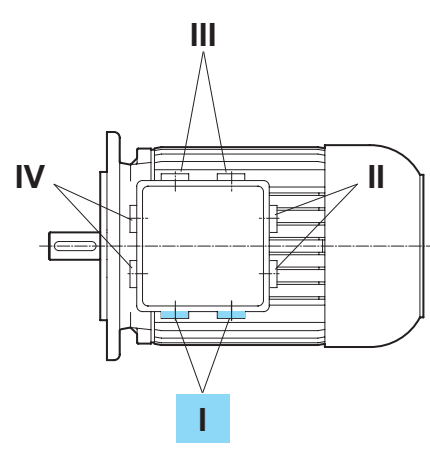



BAUREIHE NORD B5 BRE WERKNORM

Motordaten

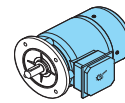
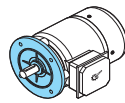
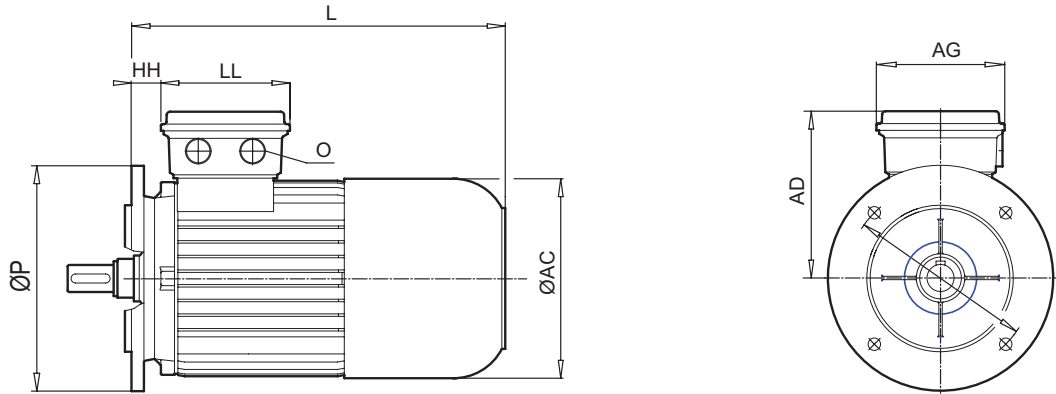

Type	IE2	IE3	WN-Pos.	P	AC	AD	AG	HH	L	LC	LL
225	SH		28	350	433	347	245	94	922	1042	245
225	SH		78	350	443	347	245	94	922	1042	245
225	SH		69	300	443	347	245	94	922	1042	245
225	MH		30	350	443	347	245	94	922	1042	245
225	MH		80	350	443	347	245	94	922	1042	245
250	WH		32	450	443	347	245	94	922	1072	245
250	WH		82	450	443	347	245	94	922	1072	245
225		RP	26	350	443	347	245	94	922	1042	245
225		RP	76	350	443	347	245	94	922	1042	245
225		RP	68	300	443	347	245	94	922	1042	245
225		SP	28	350	443	347	245	94	922	1042	245
225		SP	78	350	443	347	245	94	922	1042	245
225		SP	69	350	443	347	245	94	922	1042	245
225		MP	30	350	443	347	245	94	922	1042	245
225		MP	80	350	443	347	245	94	922	1042	245
250		WP	32	450	443	347	245	94	922	1072	245
250		WP	82	450	443	347	245	94	922	1072	245

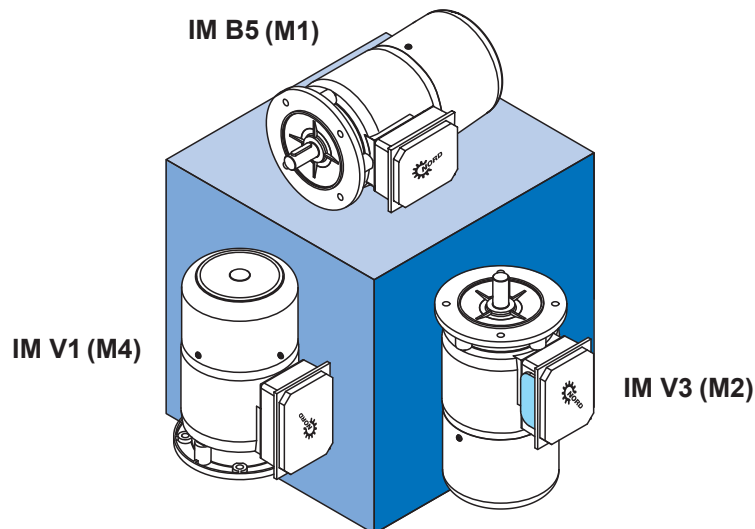

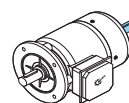
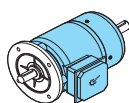
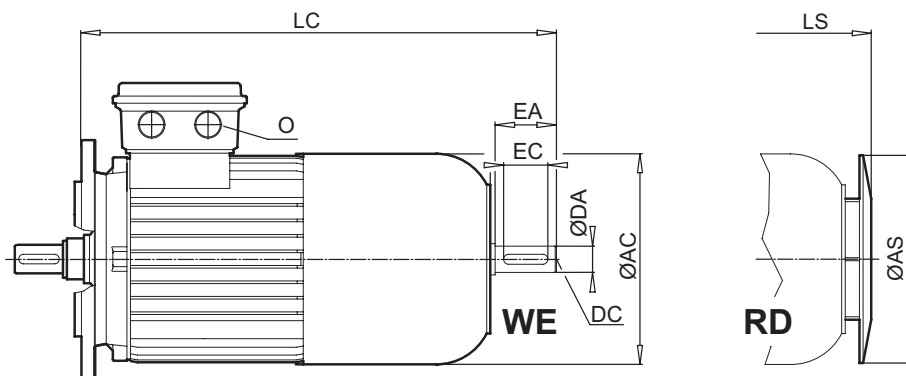

[mm]	AS	LS	O	DA	DC	EA	EC	FA	GC
	348	1008,5	M50 x 1,5	55	M20	110	100	16	59
	348	1008,5	M50 x 1,5	55	M20	110	100	16	59
	348	1008,5	M50 x 1,5	55	M20	110	100	16	59
	348	1008,5	M50 x 1,5	55	M20	110	100	16	59
	348	1008,5	M50 x 1,5	55	M20	110	100	16	59
	348	1008,5	M63 X 1,5	60	M20	140	125	18	64
	348	1008,5	M63 X 1,5	60	M20	140	125	18	64
	348	1008,5	M50 X 1,5	55	M20	110	100	16	59
	348	1008,5	M50 X 1,5	55	M20	110	100	16	59
	348	1008,5	M50 X 1,5	55	M20	110	100	16	59
	348	1008,5	M50 X 1,5	55	M20	110	100	16	59
	348	1008,5	M50 X 1,5	55	M20	110	100	16	59
	348	1008,5	M50 X 1,5	55	M20	110	100	16	59
	348	1008,5	M50 X 1,5	55	M20	110	100	16	59
	348	1008,5	M50 X 1,5	55	M20	110	100	16	59
	348	1008,5	M63 X 1,5	60	M20	140	125	18	64
	348	1008,5	M63 X 1,5	60	M20	140	125	18	64

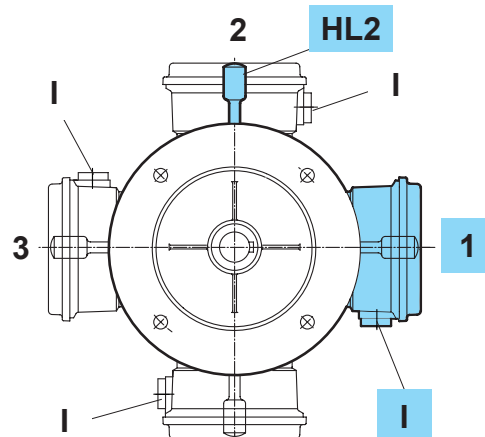
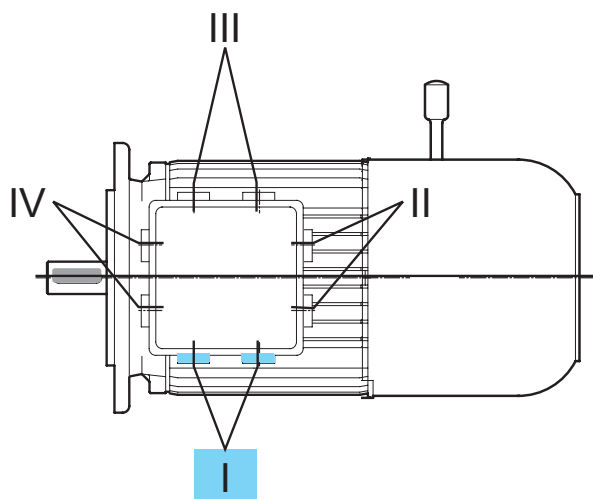



NORD DRIVESYSTEMS Group

Stammsitz und Technologiezentrum
in Bargteheide bei Hamburg

Innovative Antriebslösungen
für mehr als 100 Industriezweige

Mechanische Produkte
Flach-, Stirn-, Kegelrad- und Schneckengetriebe

Elektrische Produkte
IE 2/IE3/IE4-Motoren

Elektronische Produkte
zentrale und dezentrale Frequenzumrichter,
Motorstarter, Feldverteiler

7 technologisch führende Fertigungsstandorte
für alle Antriebskomponenten

Tochtergesellschaften und Vertriebspartner
in 89 Ländern auf 5 Kontinenten
bieten Vor-Ort-Bevorratung, Montagezentren,
technische Unterstützung und Kundendienst.

Mehr als 4.000 Mitarbeiter weltweit
schaffen kundenspezifische Lösungen.

www.nord.com/locator

Ⓓ Getriebebau NORD GmbH & Co. KG, Getriebebau-Nord-Str. 1, D-22941 Bargteheide
Fon +49 (0) 4532 / 289 - 0 , Fax +49 (0) 4532 / 289 - 2253, info@nord.com

Ⓐ Getriebebau NORD GmbH, A-4030 Linz, Deggendorfstrasse 8
Fon +43 (0) 732 / 31 89 20, Fax +43 (0) 732 / 31 89 20 – 85, info.at@nord.com

Ⓒ Getriebebau NORD AG, Bächigenstrasse 18, CH-9212 Arnegg
Fon +41-71-388 99 11, Fax +41-71-388 99 15, switzerland@nord.com

Member of the NORD DRIVESYSTEMS Group



NORD
DRIVESYSTEMS